

Hours: Monday-Friday 9:00am-6:00PM

Patient Information

Date _____

Patient Name: _____ DOB: _____

Address: _____ Drug Allergies: _____

Quantity _____



- Each vial is only opened when you need it—you'll know that every dose is sterile, precise, and preservative free
- Each vial is ready to use—no drop counting. No mixing or shaking required
- **Give OTOVEL to your child twice a day for 7 days. OTOVEL is only for use in the ear. You should use OTOVEL exactly as your doctor directs. Doses should be given about 12 hours apart (for example, 8 AM and 8 PM)**
- Warm OTOVEL in your hands for 1 to 2 minutes prior to giving the dose. Putting cold liquid into the ear can cause dizziness
- Pull the upper ear back gently while you give the dose, as that helps to provide a clear path to the inner ear
- Once you've given the full dose of OTOVEL, the tragus should be pumped 4 times to help the medicine get to affected area. The tragus is the small piece of cartilage in front of the outer ear canal. After you pump the tragus, have your child lie still in place for 1 to 2 minutes

Additional Prescription Information

Additional Refills: _____

Comments: _____

Prescriber Signature: _____ **Prescriber Name:** _____

Phone: _____ **Fax#:** _____ **NPI#** _____

Confidential Information Enclosed: The information enclosed herein is intended for the use of the person or email to which it is intended for the use of the person or entity to which it is addressed and may contain information that is privileged and confidential. The disclosure of which is governed by applicable law. If the reader of this message is not the intended recipient, you are hereby notified that any dissemination or copying of this information is **STRICTLY PROHIBITED**. If you have received this information by mistake, please notify sender immediately and return the enclosed information.

FREE DELIVERY AND SHIPPING

INSTRUCTIONS FOR USE

OTOVEL (OH-toe-vel)

(ciprofloxacin and fluocinolone acetonide)
otic solution

Read this Instructions for Use that comes with OTOVEL before you start using it and each time you get a refill. There may be new information. This information does not take the place of talking with your healthcare provider about your medical condition or treatment.

Important information about OTOVEL:

- OTOVEL is for use in the ear only (otic use). Do not inject OTOVEL or use OTOVEL in the eye.
- Use OTOVEL exactly as your healthcare provider tells you to use it.

How should I use OTOVEL?

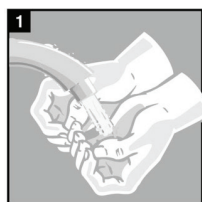

Step 1.
You or your caregiver should wash their hands with soap and water.

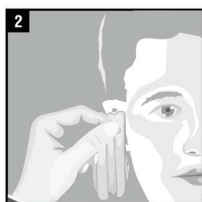

Step 2.
Gently clean any fluid (discharge) from the outer ear using a clean cloth or tissue. Do not put a cotton swab or any other object in the ear canal.

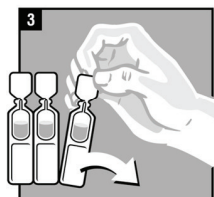

Step 3.
Remove OTOVEL from the protective foil pouch. Pull apart 1 single-dose vial of OTOVEL as shown, by tearing along the dotted lines (perforations) until it is fully separated.

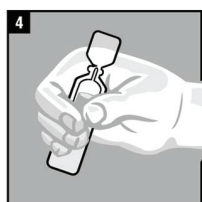

Step 4.
Warm the dose of OTOVEL by holding the vial in your hand for 1 to 2 minutes.

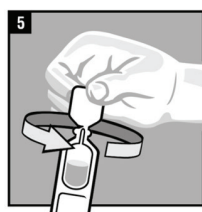

Step 5.
Twist off the vial cap in the direction of the arrow as shown.

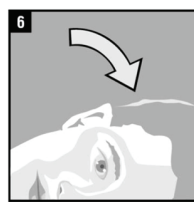

Step 6.
The person receiving OTOVEL should be on his/her side with the infected ear up as shown.

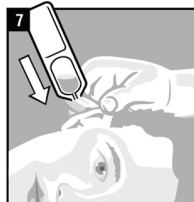

Step 7.
Hold the vial of OTOVEL in your hand and place the vial close to the ear. Let the entire dose of OTOVEL fall into the affected ear.

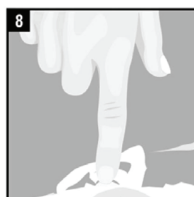

Step 8.
Gently press the part of the ear known as the tragus 4 times using a pumping motion as shown. This will allow the drops of OTOVEL to enter the middle ear.



Step 9.
Remain on your side with the affected ear facing upward for 1 minute.

Step 10.
If your healthcare provider has told you to use OTOVEL in both ears, repeat Steps 2-9 for the other ear.

Step 11.
Safely throw away OTOVEL vials after use.